



|                                                                                                |
|------------------------------------------------------------------------------------------------|
| <b>Project Name:</b> _____<br><b>Location:</b> _____<br><b>Item #:</b> _____ <b>Qty:</b> _____ |
|------------------------------------------------------------------------------------------------|

**Model: TRC84FG & TRC84CG 10-Pan Refrigerated Condiment Rail**

ThermalRite Refrigerated Cold Wall Condiment Rail can be purchased separately or as part of one of our complete ThermalRite prep table units. This unit can be used for any prep table with an overall width of at least 84". This condiment rail is designed to keep refrigerated ingredients close at hand in a glass-protected environment. This self-contained refrigeration unit is manufactured with the highest regard for quality and energy efficiency.



**TRC84FG**

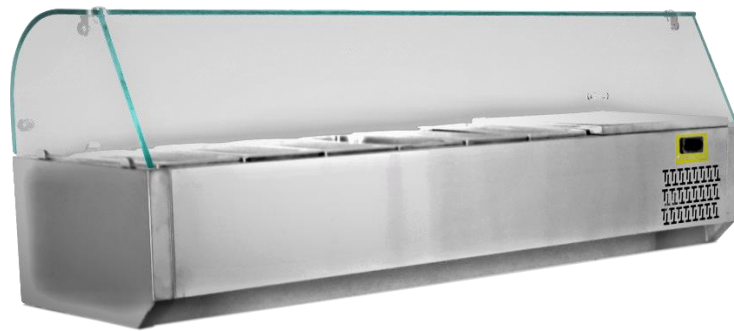

**TRC84CG**

**Standard Feature**

- Easy-to-use touch screen control, with built in power switch.
- Energy-efficient refrigeration system.
- Ecological R134A refrigerant
- Rear breathing, front exhaust, keeps the dust from clogging the condenser coil.
- High performance polyurethane foam insulation
- Manual defrost
- AISI 304 Grade Stainless Steel interior and exterior
- Interior rounded corners for easy cleaning
- Holds 10 - 1/3-pans (not included)
- Meets the guideline demands of HAACP
- Flat glass sneeze guard

**Warranty**

- 2-years parts and labor warranty

**Options**

- Curved glass sneeze guard

|                                                                                                                                                                                                                                                                                                                                                                                                                                                                                                                                                  |
|--------------------------------------------------------------------------------------------------------------------------------------------------------------------------------------------------------------------------------------------------------------------------------------------------------------------------------------------------------------------------------------------------------------------------------------------------------------------------------------------------------------------------------------------------|
| <p><b>Specifications for TRC84FG &amp; TRC84CG Refrigerated Condiment Rail</b></p> <p>ThermalRite Refrigerated Condiment Rail, an above-the counter, refrigerated glass display unit, can be purchased separately or as part of one of our complete prep table units.</p> <p><b>PAN CAPACITY</b><br/>10- 1/3-pans (not included)</p> <p><b>DIMENSIONS</b><br/>84"W x 16.13"D x 19.56"H</p> <p><b>ELECTRICAL SUPPLY</b><br/>120VAC/60HZ/1PH</p> <p><b>HP</b><br/>1/12</p> <p><b>FLA/Circuit Ampacity</b><br/>2/15</p> <p><b>WATTS</b><br/>283</p> |
|--------------------------------------------------------------------------------------------------------------------------------------------------------------------------------------------------------------------------------------------------------------------------------------------------------------------------------------------------------------------------------------------------------------------------------------------------------------------------------------------------------------------------------------------------|

|                                                                             |                         |
|-----------------------------------------------------------------------------|-------------------------|
|                                                                             |                         |
| CONFORMS TO UL STD.471<br>CERTIFIED TO CSA STD.C22.2<br>No.120 & NSF/ANSI 7 | <b>Date:</b><br>04/2018 |



Project Name: \_\_\_\_\_  
 Location: \_\_\_\_\_  
 Item #: \_\_\_\_\_ Qty: \_\_\_\_\_

**Model: TRC84FG & TRC84CG 10-Pan Refrigerated Condiment Rail**

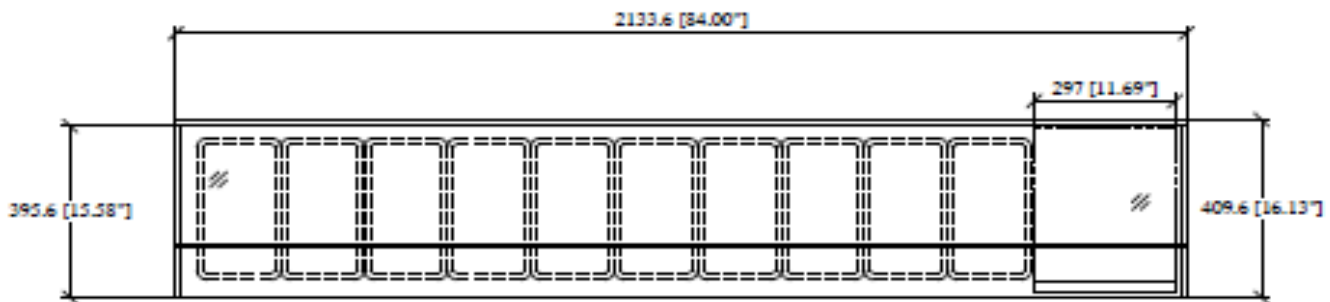
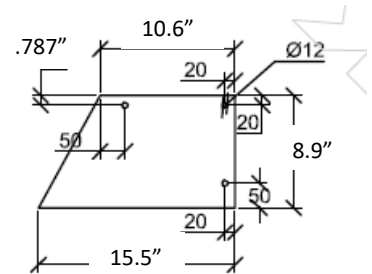
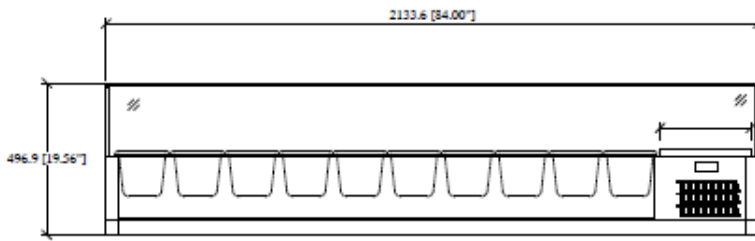

**Standard Features Design**

ThermalRite Refrigerated Condiment Rails, are an outstanding value in today's foodservice marketplace. Ample pan capacity provides space to keep your ingredients at the right temperatures. Focusing on the latest technology and high-quality materials and components, this unit offers reliable product temperatures, lower utility costs, and the ability to adhere to food safety standards.

**Model Features**

- 2" digits on digital display.

- Rounded interior corners for easy cleaning

**Cabinet Construction**

- Sturdy, stainless steel construction for durability and to resist scratches and dents.
- High performance polyurethane foam.
- Insulation thickness of 2" is more than that offered by most competitors
- Interior rounded corners for easy cleaning

**Refrigeration System**

- Factory engineered, self-contained cold wall system using environmentally friendly, CFC-free R134a refrigerant.

**Electrical**

- Unit completely pre-wired at factory and ready for final connection to a dedicated outlet
- Cord and plug included
- 115VAC/60Hz/1PH 15amp

**Warranty**

- 2-year Warranty on parts and labor

| TRC84FG<br>TRC84CG | DIMENSIONS |       |        | AMBIENT<br>TEMP | SHIPPING   |                       |            |     |
|--------------------|------------|-------|--------|-----------------|------------|-----------------------|------------|-----|
|                    | WIDTH      | DEPTH | HEIGHT |                 | DIMENSIONS | WEIGHT                |            |     |
|                    | 84"        | 16.15 | 19.56  |                 | 100 °F     | 88" x 20.15" x 24.00" | 280        |     |
| ELECTRICAL DATA    |            |       |        |                 |            |                       | COMPRESSOR |     |
| VOLTS              | HZ         | PH    | AMPS   | AMP FUSE        | NEMA       | CORD LENGTH           | WATT       | HP  |
| 120                | 60         | 1     | 2.36   | 15              | 5-15P<br>  | 8'                    | 283        | 1/8 |



**Every Step of the Way**

15600 37th Avenue N, Suite 100  
 Plymouth, MN 55446  
 1-800-328-3968

Specifications subject to change without notice.

TRC84 042018